

BARCOREALITY 812

12" CRT Projector with Unsurpassed Brightness and Resolution



Thanks to its unique 12" CRT tubes, the BARCOREALITY 812 is breaking new ground for the CRT technology. The 500 ANSI lumen of the BARCOREALITY 812 more than doubles the conventional light output of most 'high-performance' CRT projectors available today. Light output is no more a compromise for CRT projection. The electronics of the BARCOREALITY 812 can handle the most severe geometric corrections for high demanding applications such as: simulation, VR immersive environments, design centers, ultra-high performance graphics,...

Unprecedented light output and resolution

Thanks to its unique 12" CRT tubes, the BARCOREALITY 812 can write the same amount of pixels displayed by conventional 9" projectors on a phosphor area nearly twice as large (cf. picture). As adjacent pixels have less overlapping, this results in the highest projection performance, both in resolution and light output, ever achieved by CRT projectors.

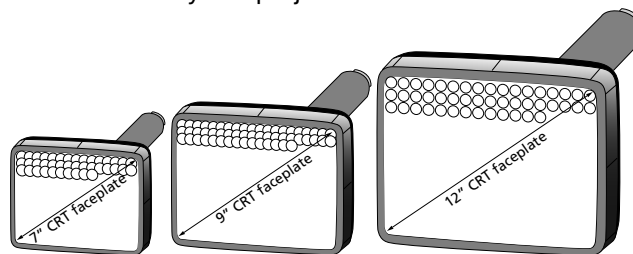

Built-in IRIS³ Automatic Convergence

The built-in IRIS³ Automatic Convergence system aligns on-screen convergence in less than 2.5 minutes.

Easy integration

The design of the BARCOREALITY 812 is based on Barco's advanced electronics-optics separation concept. The compactness and unmatched accessibility of the separate optics and electronics modules enables easy and flexible integration of the BARCOREALITY 812 in most environments.

Outstanding image quality

The fully color corrected lenses of the BARCOREALITY 812, combined with its superb 12" CRTs, provide outstanding image quality with unparalleled color saturation.



Technical Specifications

Light Output

ANSI lumen:
 Economy Mode: 350 lumens
 Normal Mode: 410 lumens
 Boost Mode: 500 lumens

CRTs

High brightness, ultra-high definition liquid cooled 12" electromagnetic focus CRTs

Lenses

Ultra-high definition, fully color corrected, liquid cooled lenses

Screen sizes

Min.: 2.4 m x 1.8 m (7,9' x 5,9')
 Max.: 7.0 m x 5.25 m (23' x 17.3')

Scan Frequencies

Horizontal: 15 - 110 kHz autolock
 Vertical: 37 - 200 Hz autolock

Minimal Retrace Time

Horiz.: < 2.5 μ s
 Vert.: < 300 μ s

RGB Bandwidth

120 MHz [-3 dB]

Horizontal Linearity

< ± 1.5 % distortion throughout the full horizontal frequency range

Inputs

- RGB or Component (R-Y, B-Y, Y) input on 5 BNC-connectors, with sync on green or separate sync, automatic sync detection and sync polarity
- RGB analog input on D9-connector with automatic sync detection and sync polarity (optional D9-BNC adapter available)
- Video (PAL/ SECAM/ NTSC 4.43 / NTSC 3.58), loop-through (2xBNC) with 75 Ohm termination switch
- S-Video input (4-pin mini-DIN), loop through with 75 Ohm termination switch (can also be programmed as a second Video input)

Special Features

- CRT drive in 3 modes: normal mode, economy mode for longer lifetime of the CRTs, and boost mode for special applications
- Multi-language on-screen menus: English, French, German and Spanish
- 32 frequency-related memory banks
- LDI (linear digital interpolation)
- Ability to set parameters to midposition
- Color temperature adjustment (3200K, 4900 K, 6500K, 9300K or custom)
- A built-in Scheimpflug optical correction, with stepless adjustments for both horizontal and vertical axis
- 'Seagull' correction to improve corner geometry
- Built-in projection distance calculator
- Built-in IRIS³ Auto-Convergence unit
- Optional fast green CRT for stereoscopic projection
- Separate electronics and CRT module with interconnection cable (2 m length)

Power Consumption

700 W

Safety regulations

The BARCOREALITY 812 complies with UL1950 and EN60950

Electromagnetic interference

The BARCOREALITY 812 complies with FCC part 15 Class B (120 V version) and CE EN55022 Class B (230 V version)

Weight

Electronics module: 20 kg (44 lbs)
 CRT module: 130 kg (287 lbs)

Order information

BARCOREALITY 812
 230 VR9002180 R9002189
 120 V
 RCVDS 05 source selector
 230 V R9827880
 120 V R9827889
 Projector Control software R9827530
 Remote infrared receiver R9827515

Line Doubler Kit (LiDo) R9828161

D9-BNC cable adapter R9827840

Communication cables

• 5 m (16 ft.) R9827770

• 15 m (50 ft.) R9827560

• 30 m (100 ft.) R9827570

Ceiling Mount 808/1200

• with Pulley System R9827341

• without Pulley System R9827342

Special add-in boards

• Contrast Modulation Kit R9828145

• Orbiting Kit R9827781

• Convergence on green R9828080

Electronics Module

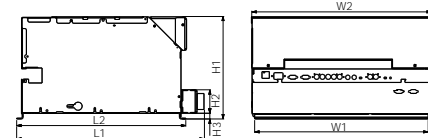

CRT Module

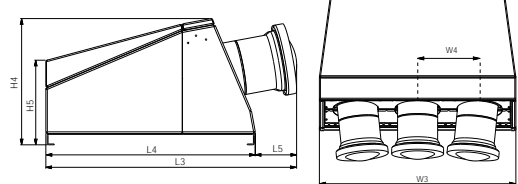

Dimensions	mm	inch
L1	587	23.11
L2	530	20.87
L3	930	36.61
L4	780	30.71
L5	150	5.90
H1	320	12.60
H2	73.5	2.89
H3	18	0.71
H4	450	17.72
H5	300	11.81
W1	544	21.42
W2	563	22.17
W3	952	37.48
W4	300	11.81
W5	821	32.33

Barco Projection Systems is an ISO 9001 registered company.

The information and data given are typical for the equipment described. However any individual item is subject to change without any notice.



Barco Simulation Products
 A division of Barco Projection Systems

Headquarters:
 Noordlaan 5 8520 Kuurne, Belgium
 Tel: +32 56 36 82 11 Fax: +32 56 36 84 86
 E-mail : sales.bps.bsp@barco.com

In the US:
 3240 Town Point Drive
 Kennesaw, GA 30144-3682 USA
 Tel: (770) 218-3200 Fax: (770) 218-3250
 E-mail: brian.overy@barco.com

Visit Barco at www.barco.com

